

SPECIFICATIONS

Sufaced&Recessed Door trigger/
Hand shaking delay sensor switch



Item No.: SXA-A4 / SXA-2A4

Version: V1

Date: 2022-07-28

Product Picture



SXA-A4P Single sensor switch



SXA-2A4P Double sensor switch

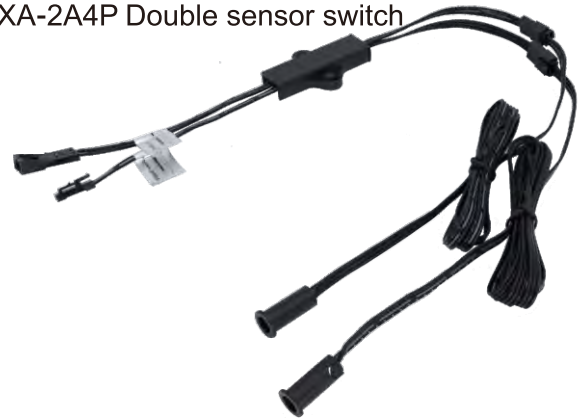

FUNCTION DESCRIPTION

1. Short press the switch on the control shell ,can change the door trigger and hand shaking function mode. Have memory function,when the power on again,and the sensor will keep the function mode before power failure. Factory default functions can be customized.

2. When the sensor is door trigger moede,the door if open,the light will turn on and keep 1 hours, then the light will turn off. If you close the door and open it again, the light will turn on again.

TECHNICAL DATA

Item No.	SXA-A4	SXA-2A4
Function	Single mode change	Double mode change
Voltage	DC12V / DC24V	
Max Wattage	60W	
Material	Black plastic	
Color	Customized	
Size	Ø 10X20mm	
Installation size	Ø 8X20mm	

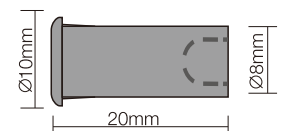
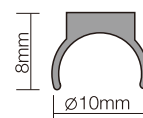

DETAILS

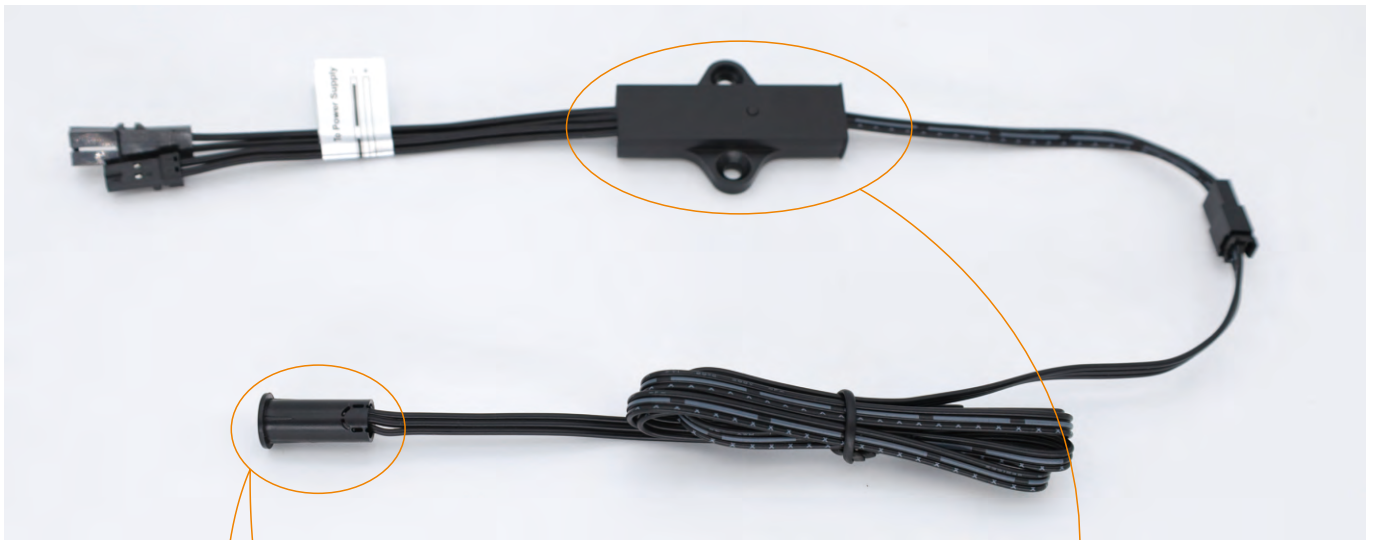

PACKAGE



Single package



Size: 450x340x280mm

INSTALLATION

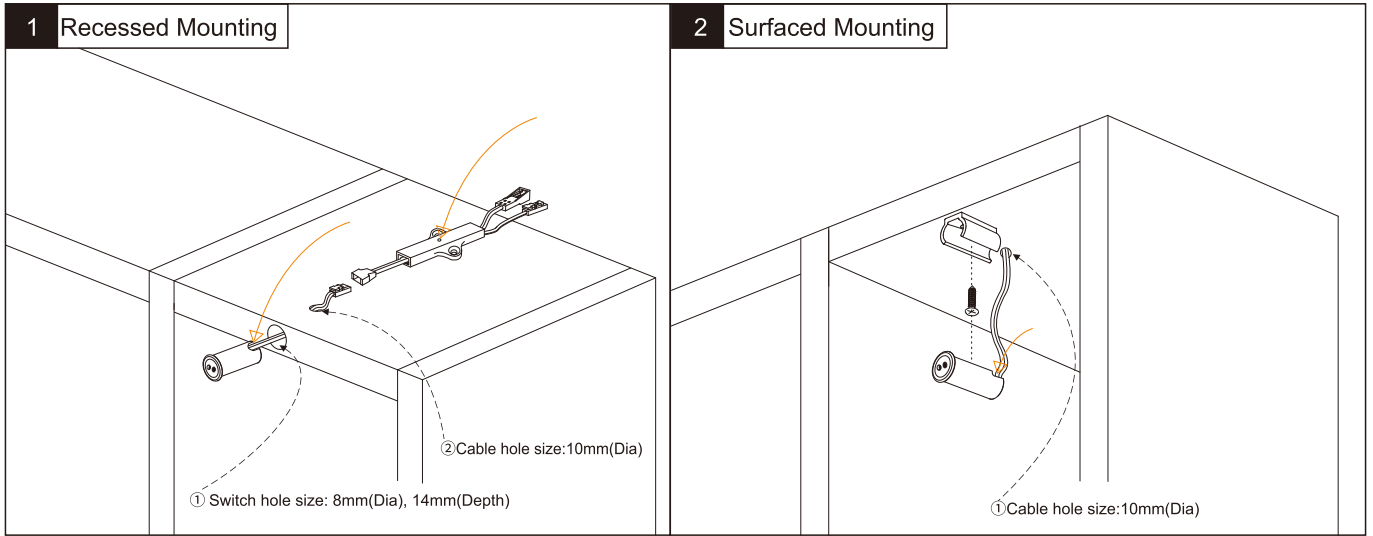

1. It can be cut off here to facilitate the wiring during installation

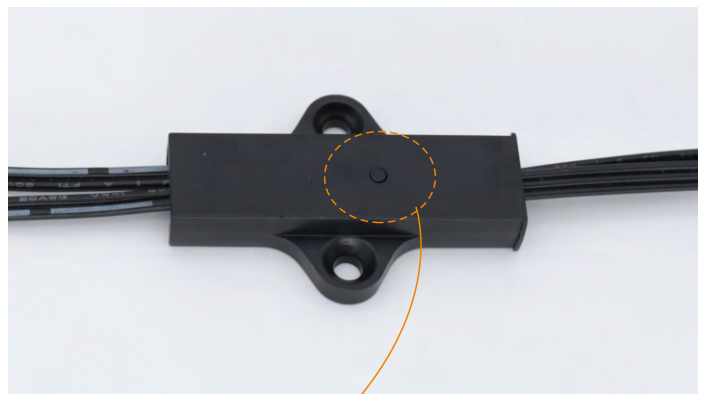

2. Dual induction switch change button

CONNECTION DIAGRAM

LED driver+ S2A-A4 Switch+ LED

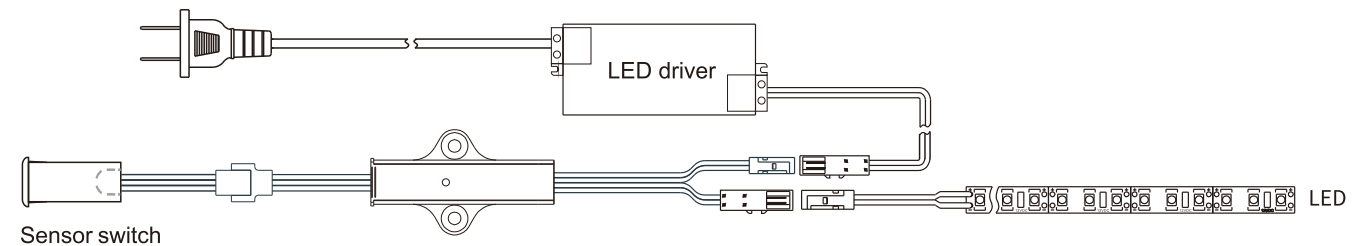

→ Output: Female plug (Cable with letter is positive)

→ Input: Male plug (Cable with letter is positive)

APPLICATION

Mainly used for bedroom wardrobe lights, furniture local lighting, bathroom mirror lighting system control, etc.



NOTES

1. For indoor use only.
2. Do not disassemble the product.
3. Do not install the switch in water dropping place.
4. Use a dry cloth, never a strong cleaning agent.
5. Replace all set switch device if case of quality or malfunction.